

# Welcome to Madrid

---

## **CLOSED UNTIL FURTHER NOTICE**

---

**In the heart of Madrid, this 1900 building, that used to be home to the Mahou brewery, is now home to a hip cultural space. The building was first designed by the Spanish architect José López Salaberry later converted into a museum with an underground gallery and triangular windows by the Aranguren & Gallegos studio. The result is a project that not only renovates the space for its new use, but also beautifies the urban setting by providing the city with an innovative building that respects its original architecture.**

The Museum has an area of over 3,800m<sup>2</sup> distributed in six floors, two of which are underground. It has two large Exhibition Halls, Multifunctional Halls, a floor for offices, the Storage Room of the ABC Collection, a Restoration Workshop, a Warehouse, a Glass Room for events and the Bookstore Espacio Edelvives.

The exhibition rooms were launched with the “Iceberg Effect” show, a retrospective of the ABC Collection that was conceived in 1891 and continued to grow thereafter. In addition to the conservation, study and public display of the ABC Collection, the new museum is a living space and a home for such disciplines as comics and animation, welcoming both specialists and the general public alike.

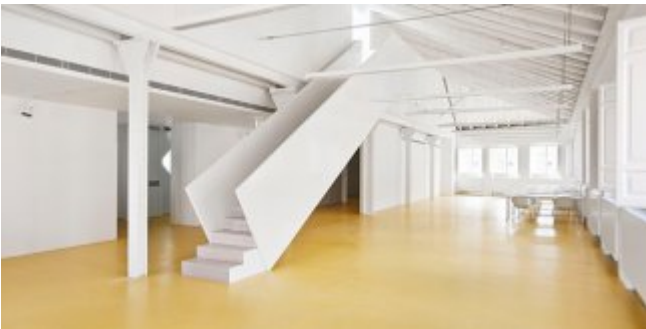

## Services

- |  |                       |   |                             |
|--|-----------------------|---|-----------------------------|
|  | Ascensor              |  | Consigna / Guardarropa      |
|  | Puntos de información |  | Servicio de visitas guiadas |

## Interest data

### Address

Calle de Amanuel, 29 - 31 28015

### Telephone

(+34) 91 758 83 79

### Web

<http://museo.abc.es>

### Bus

001, 002, 1, 2, 3, 44, 62, 74, 75, 133, 138, 147, C1, C2

### Opening times

Tue - Sat 11.00 - 20.00 h.

Sun 10.00 - 14.00 h.

Mondays, 1 and 6 January, 1 May, 24, 25 and 31 December: Closed

### Tourist area

Conde Duque

### Email

[info\\_museo@abc.es](mailto:info_museo@abc.es)

### Metro

Noviciado (L2, L3, L10), Plaza de España (L2, L3, L10), San Bernardo (L2, L4), Ventura Rodríguez (L3)

### Price

Free entry.

Recommended Donation: € 3



PÁGINA OFICIAL DE TURISMO DE LA CIUDAD DE MADRID

